

GENERAL FLOOR AREA = 1979m²

BUILDING 1	BUILDING 2	BUILDING 3
G. FLOOR = 197 m ²	G. FLOOR = 338 m ²	G. FLOOR = 381 m ²
F. FLOOR = 286 m ²	F. FLOOR = 338 m ²	F. FLOOR = 439 m ²
TOTAL = 483 m ²	TOTAL = 676 m ²	TOTAL = 820 m ²

RENT / USEABLE FLOOR AREA = 1889m²

BUILDING 1	BUILDING 2	BUILDING 3
G. FLOOR = 167 m ²	G. FLOOR = 276 m ²	G. FLOOR = 351 m ²
F. FLOOR = 286 m ²	F. FLOOR = 338 m ²	F. FLOOR = 439 m ²
TOTAL = 453 m ²	TOTAL = 614 m ²	TOTAL = 790 m ²

CARPARK SPACES = 63

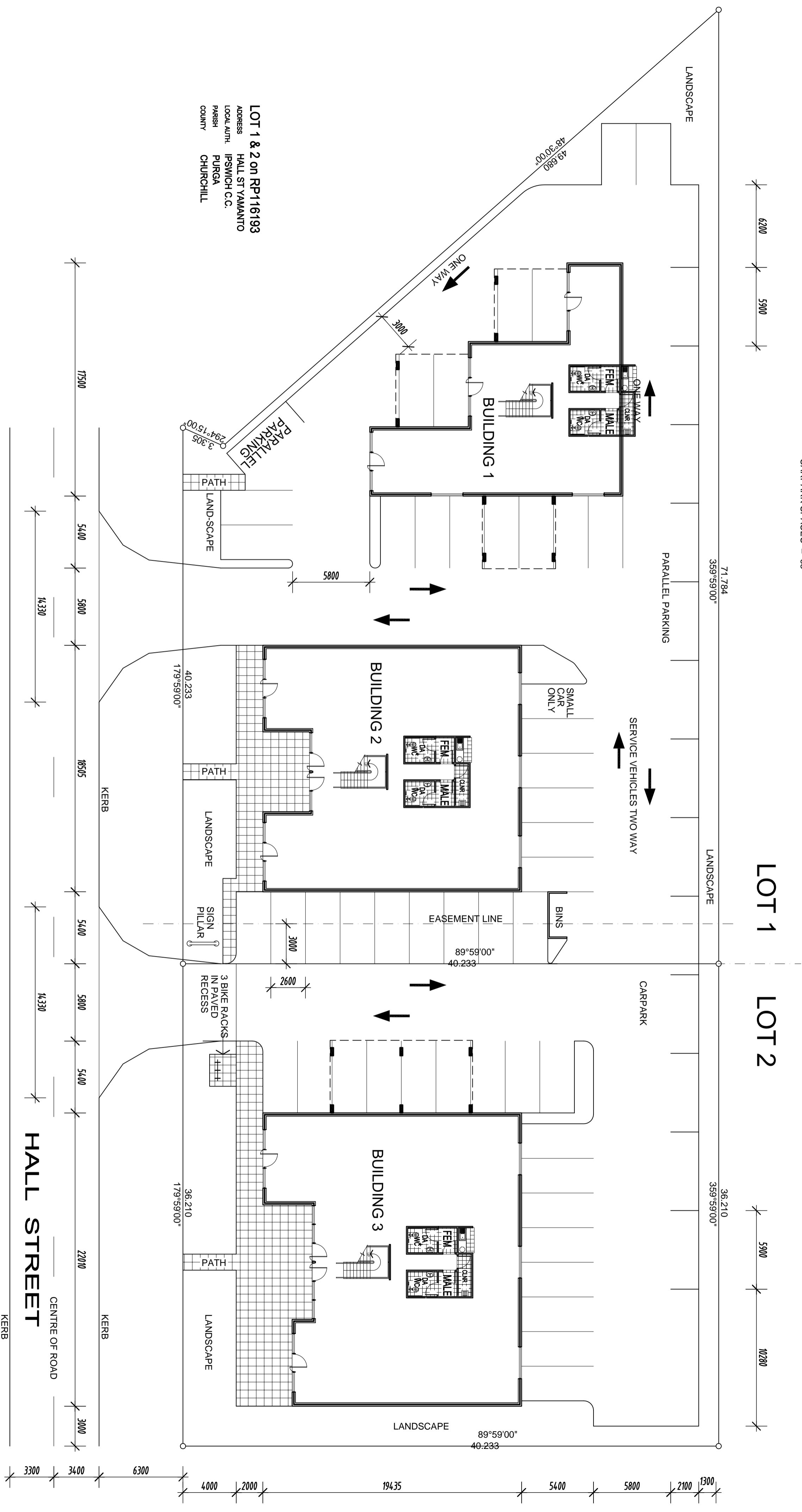

LOT 1 & 2 on RP116193
 ADDRESS HALL ST YAMANTO
 LOCAL AUTH. IPSWICH C.C.
 PARISH PURGA
 COUNTY CHURCHILL



LFP Architects Pty. Ltd
 Phone : 0422 866532
 P.O. Box 758, Mudgeeraba, 4213
 Email : lfparchitects@iprimus.com.au

COPYRIGHT
 This plan is the property of LFP and may not be used in whole or in part. Legal action may be taken against any person infringing the copyright.

SITE/FLOOR PLAN
 1:200 @ A2

PROJECT PROPOSED OFFICE DEVELOPMENT
 AT LOT 1 & 2 HALL ST YAMANTO
 FOR

Plot Date 15/10/07
 DRAWN NPK
 DATE DEC. 07
 JOB No. 01-12-06
 SHEET DA01 / B